



MARATHON COACH PRE-OWNED INVOICE

0735 EXV2S
CONSIGNMENT

VIN # 2PCV3349711014135

YEAR: 2002

Shell Specs

Converter: MARATHON COACH, INC.
Shell Type: PREVOST H3-45
Motor: DETROIT DIESEL SERIES 60
Transmission: ALLISON SIX SPEED
Mileage: PLEASE CALL FOR UPDATED MILEAGE
Jacobs Brake / Retarder: JACOBS BRAKE
O. T. R./ Drivers A C: DRIVERS A/C
Tires: MICHELIN
Exterior Colors: CREAM, SAND AND MEDIUM BLUE

Interior Specs

Interior Colors: IVORY AND COBALT
Floorplan: [P] OFFSET AISLE
Bed Arrangement: CROSS JR. KING
Cabinet Color: "CASHMERE BIRDSEYE"
Counter Color: "LINEN"
Carpet Color: "CASTILLIAN"

ADD'L INFO AVAILABLE AT
WWW.MARATHONCOACH.COM

Equipment Listing

Interior

ONE FABRIC SOFA
TWO LEATHER RECLINERS
TABLE AND CHAIRS DINETTE
WOOD PLANK FLOORING IN SALON,
TRAVERTINE FLOOR IN BATH
FLIP DOWN COCKPIT TV
BEDROOM TV
STEREO IN DASH AND BEDROOM
CD CHANGER

AMANA REFRIGERATOR
GAGGENAU COOKTOP
SHARP CONVECTION MICROWAVE
ASKO STACK WASHER DRYER
DISHWASHER
CEILING FAN IN BEDROOM
TEMP SENSING SHOWER VALVE
GARMIN GPS MAPPING
TECHLINK ELECTRICAL SYSTEM

Exterior

HWH SALON AND BEDROOM SLIDEOUTS
HOT ROD FENDER PACKAGE
FULL AWNING PACKAGE
IN MOTION SATELLITE
REAR VIEW CAMERA
CUSTOM DESIGN PAINT SCHEME

HID HEADLIGHTS AND FOG LIGHTS

Underbelly

20KW KOHLER GENERATOR
TWO TRACE 4000W INVERTER
TWO 10.5 GALLON WATER HEATERS
110V WATER PUMP
HOT / COLD WATER MANIFOLD SYSTEM
ELECTRIC SHORE CORD REEL
ELECTRIC DUMP VALVES
FOUR CRUISAIR A/C UNITS

Tank Capacities

FUEL CAPACITY	<input type="text" value="235 GALLONS"/>	FRESH TANK CAPACITY	<input type="text" value="186 GALLONS"/>
LP GAS CAPACITY	<input type="text" value="N/A"/>	GREY TANK CAPACITY	<input type="text" value="119 GALLONS"/>
		BLACK TANK CAPACITY	<input type="text" value="68 GALLONS"/>

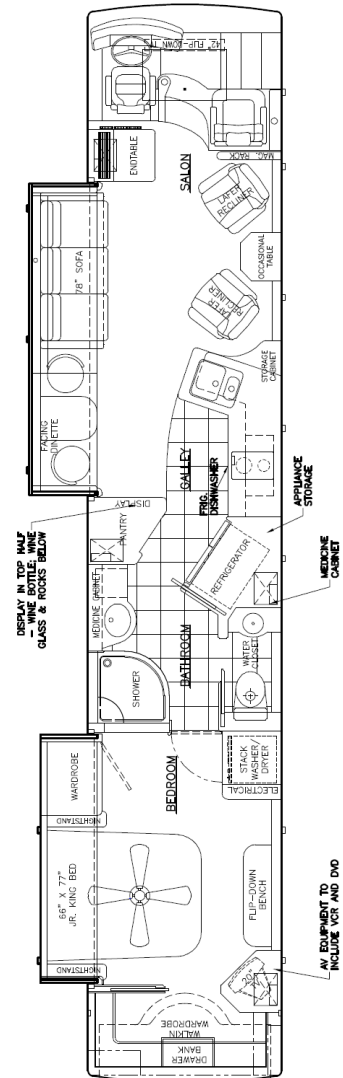

All Prices And Options Are Subject To Change Without Notice.
Although We Try To Provide Accurate Information, It Is Not Guaranteed. Equipment Important To The Customer Should Be Personally Verified.