



MARATHON COACH

PRE-OWNED INVOICE

1285 X3-45
CONSIGNMENT

VIN # 2PCBS3491JC736274

YEAR: 2019

Shell Specs

Converter: MARATHON COACH
Shell Type: PREVOST X3-45
Motor: VOLVO D13
Transmission: ALLISON SIX SPEED
Mileage: CALL FOR CURRENT MILEAGE
Jacobs Brake / Retarder: RETARDER
O. T. R./ Drivers A C: DRIVERS A/C
Tires: MICHELIN
Exterior Colors: BLACK, GRAY, BROWN, TAN

Interior Specs

Interior Colors:
Floorplan: NEWPORT BEACH
Bed Arrangement: CROSS CUSTOM
Cabinet Color: TUSCAN OLIVE WOOD
Counter Color: WINDSWEPT PRIMA (SATIN)
Carpet Color:

ADD'L INFO AVAILABLE AT
WWW.MARATHONCOACH.COM

Equipment Listing

Interior

LEATHER PILOT/CO-PILOT CHAIRS
 AIR RIDE ADJUSTABLE PILOT CHAIR
 CRESTRON A/V DASH MONITOR CONTROL
 SAMSUNG HDTV COCKPIT/SALON
 WAVE PATTERN FLOOR WOOD/TILE
 ONE LEATHER RECLINER
 LARGE OCCASIONAL TABLE
 ONE LEATHER/FABRIC SLEEPER SOFA
 FIRE PLACE INSERT
 SAMSUNG HDTV SLID OUT CURIO CABINET
 IPAD CRESTRON A/V CONTROLLERS
 L-SHAPED LEATHER/FABRIC DINETTE
 INSTA HOT WATER FAUCET
 SPEEDCOOK CONVECTION/MICROWAVE
 FISHER PAYKEL DISH WASHER DRAWER
 MIELE ELECTRIC COOK TOP
 FISHER PAYKEL REFRIGERATOR/FREEZER
 POWERED GLASS POCKET SHOWER DOOR
 WATER CLOSET WITH VANITY
 CARPET FLOOR MASTER SUITE
 WARDROBE CLOSET
 ABUNDANT STORAGE CLOSETS/DRAWERS
 REAR WALK IN CLOSET
 ASKO STACKED WASHER & DRYER
 SAMSUNG HDTV IN MASTER SUITE
 ADJUSTABLE RECLINING MASTER BED

Exterior

CUSTOM PAINT SCHEME
 RAMCO SIDE VIEW MIRRORS
 TOW PACKAGE
 REAR VIEW CAMERA
 SIDE VIEW CAMERAS
 DOCKING LIGHTS
 KEYLESS DOOR ENTRY
 GIRARD AWNING PACKAGE
 HOT ROD FENDER PACKAGE
 AI INTERCOM SYSTEM

Underbelly

CARPETED AND INSULATED STORAGE BAY
 ENTERTAINMENT BAY
 SAMSUNG HDTV PLUS A SOUND BAR
 20KW POWER TECH GENERATOR
 PLUMBING BAY WITH WASH FAUCET
 ELECTRIC SHORE CORD REEL
 FREEDOM PLUS SEWER SYSTEM
 TOW ESPAR WATER HEATERS
 TECH LINK ELECTRICAL CONTROL SYSTEM
 TWO 4000 WATT INVERTERS

Tank Capacities

FUEL CAPACITY	<input type="text" value="208 GALLONS"/>	FRESH TANK CAPACITY	<input type="text" value="152 GALLONS"/>
LP GAS CAPACITY	<input type="text"/>	GREY TANK CAPACITY	<input type="text" value="82 GALLONS"/>
		BLACK TANK CAPACITY	<input type="text" value="57 GALLONS"/>

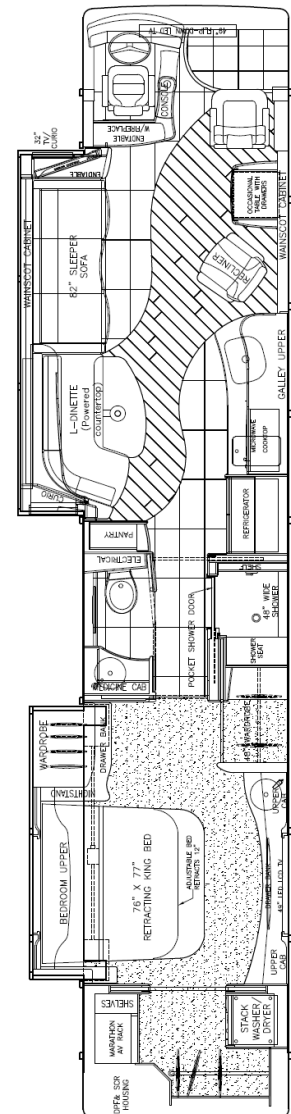

All Prices And Options Are Subject To Change Without Notice.
 Although We Try To Provide Accurate Information, It Is Not Guaranteed. Equipment Important To The Customer Should Be Personally Verified.