

CERTIFIED PRE-OWNED COACH

2011 Marathon Coach #1196

PREVOST XLII-45 DOUBLE SLIDE



www.marathoncoach.com



MARATHON COACH

PRE-OWNED INVOICE

**1196 XLV2S
WITH WARRANTY**

VIN # 2PCW334969C729606

YEAR: 2011

Shell Specs

Converter: MARATHON COACH, INC.
Shell Type: PREVOST LE MIRAGE XLII 45' DOUBLE
Motor: DETROIT DIESEL SERIES 60
Transmission: ALLISON SIX SPEED
Mileage: PLEASE CALL
Jacobs Brake / Retarder: JACOB'S BRAKE
O. T. R./ Drivers A C: DRIVERS A/C
Tires: MICHELIN
Exterior Colors: DARK BROWN, GOLDEN TAN AND

Interior Specs

Interior Colors: COFFEE AND SANDSTONE
Floorplan: [X2-M] OFFSET ANGLED AISLE
Bed Arrangement: CROSS JR. KING BED
Cabinet Color: BURNISHED CHESTNUT
Counter Color: CAPUCCINO AND MACADAMIA
Carpet Color:

Retail Price: \$799,000.00

Equipment Listing

Interior

ONE SLEEPER SOFA
 ONE LEATHER RECLINER
 LEATHER L-SHAPED DINETTE SEAT
 WOOD FLOORING THROUGHOUT
 MARBLE FLOORS DINETTE AND ENTRY
 ROMAN OGEE COUNTER EDGE TREATMENT
 BEDROOM VANITY
 SUB ZERO REFRIGERATOR
 MIELE COOKTOP
 ASKO STACK WASHER DRYER
 FISHER PAYKEL DISH DRAWER
 CONVECTION MICROWAVE
 CRESTRON CONTROL SYSTEM
 TECHLINK ELECTRICAL SYSTEM
 OFFSET GEOMETRIC CEILING WITH LED
 PRIVATE WATER CLOSET
 REAR WALK-IN WARDROBE AREA
 CUSTOM TILE SHOWER
 TEMP SENSING SHOWER VALVE
 46" SAMSUNG FLIP DOWN TV IN SALON
 48" SAMSUNG TV IN BEDROOM
 32" SAMSUNG TV IN SALON SLIDE
 ROMAN SHADES IN BEDROOM
 GPS MAPPING
 MARATHON M EDITION DESIGNED COACH

Exterior

TWO VALID SLIDES
 DARK GREEN GROUND EFFECTS LIGHTING
 AIPHONE INTERCOM SYSTEM
 CUSTOM PAINT SCHEME
 KVH IN MOTION SATELLITE (DUAL)
 COLOR BACK UP CAMERA
 STAINLESS STEEL RUB RAILS
 FOUR 15000 BTU ROOF AIR UNITS
 GIRARD AWNING PACKAGE

Underbelly

20 KW KOHLER GENERATOR
 TWO TRACE 4000W 24V INVERTERS
 TWO 10.5 GALLON WATER HEATERS
 FREEDOM PLUS SEWER SYSTEM
 ELECTRIC SHORE CORD REEL
 40,000 BTU WEBASTO
 HOT/COLD WATER MANIFOLD SYSTEM
 AUX. 110V AIR COMPRESSOR
 6.5" TECHLINK MONITOR AT WATER BAY
 ENTERTAINMENT CENTER
 40" SAMSUNG TV

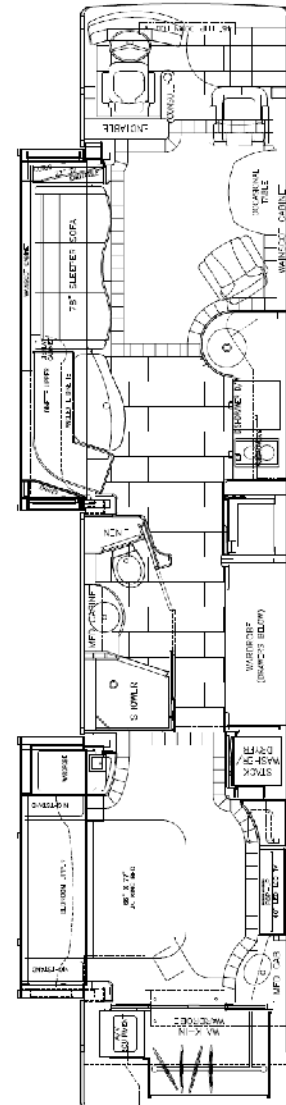

Tank Capacities

FUEL CAPACITY	<input type="text" value="208 Gallons"/>	FRESH TANK CAPACITY	<input type="text" value="154 Gallons"/>
LP GAS CAPACITY	<input type="text" value="N/A"/>	GREY TANK CAPACITY	<input type="text" value="78 Gallons"/>
		BLACK TANK CAPACITY	<input type="text" value="50 Gallons"/>

All Prices And Options Are Subject To Change Without Notice.
 Although We Try To Provide Accurate Information, It Is Not Guaranteed. Equipment Important To The Customer Should Be Personally Verified.